

- RELIEF VALVE TO BE PLUMBED TO THE EXTERIOR OF BUILDING. WATER HEATER TO BE PLACED ON 1 HR. FLOOR CONSTRUCTION A MINIMUM OF 18" HIGH
U.P.C. 608.5
- GLAZING IN HAZARDOUS LOCATIONS SHALL BE OF SAFETY GLASS. EACH LIGHT OF SAFETY GLASS SHALL BE IDENTIFIED BY SAFETY LABEL VISIBLE AFTER INSTALLATION.
IRC 308.1
- PROVIDE AT LEAST ONE OPERABLE WINDOW OF NOT LESS THAN 5.7 S.F. OF OPENABLE AREA, WITH CLEAR MINIMUM HEIGHT 24" AND WIDTH 20". MAXIMUM SILL HEIGHT 44" ABOVE FINISHED FLOOR.
IRC 310.1
- WHOLE HOUSE VENTILATION SHALL COMPLY WITH THE 2006 WA STATE VENTILATION & INDOOR AIR QUALITY CODE 302.3. - ALL BATHROOMS, TOILET COMPARTMENTS, LAUNDRY ROOMS, CLOSETS CONTAINING LAUNDRY FACILITIES, AND KITCHENS SHALL BE PROVIDED WITH MECHANICAL MEANS SYSTEM CONNECTED DIRECTLY TO THE OUTSIDE.
VIAQ SECTION 302
- CENTRAL FURNACES SHALL NOT BE LOCATED IN SPACE LESS THAN 12" WIDER THAN THE FURNACE INSTALLED THEREIN WITH A MIN. CLEAR WORKING SPACE LESS THAN 6" ALONG THE SIDES, BACK AND TOP OF THE FURNACE.
IRC M1305 & M1701.4, IMC 303
- APPLIANCES DESIGNED TO BE FIXED IN POSITION SHALL BE FASTENED OR ANCHORED IN AN APPROVED MANNER, IN SEISMIC DESIGN CATEGORIES D1 AND D2.
M1307.2
- WATER HEATER TO BE ANCHORED TOP AND BOTTOM TO RESIST HORIZONTAL DISPLACEMENT DUE TO EARTHQUAKE MOTION. STRAPPING TO BE WITHIN THE UPPER 1/3 OF THE APPLIANCE
U.P.C. 510.3 & 510.5
- VENTILATION OPENINGS SHALL BE PROVIDED WITH CORROSION-RESISTANT WIRE MESH, WITH 1/8" MINIMUM TO 1/4" MAXIMUM OPENINGS.
IRC 806.1
- 22" x 30" ATTIC ACCESS W/1/2" DAM
IRC 807.1

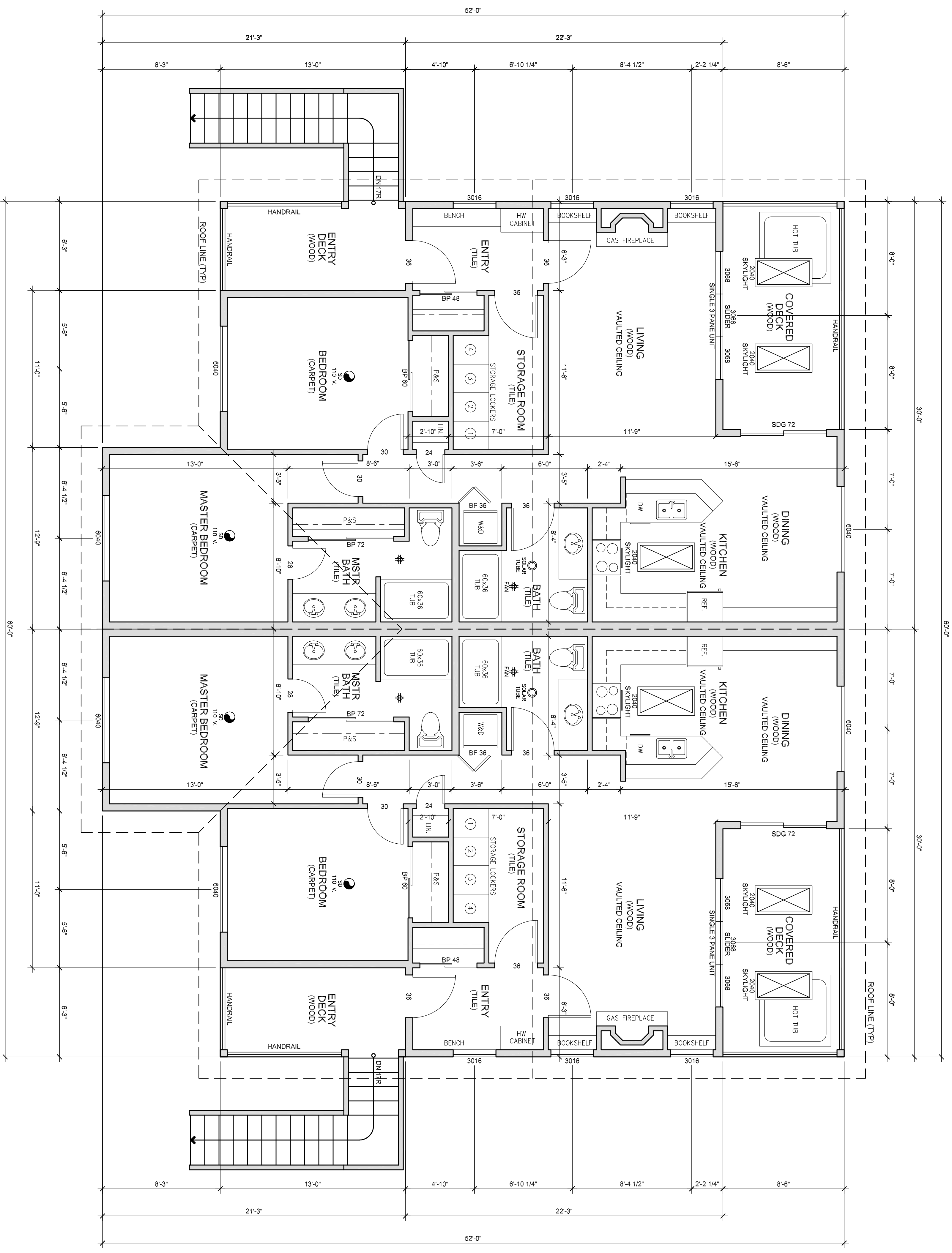

UPPER FLOOR PLAN
SCALE 1/4"=1'-0"

MT. BAKER TRAIL HEAD GROUP INC

PO BOX 28567
BELLINGHAM, WA 98228
PH: (360) 398-9333

REVISIONS:	
CONDITIONAL USE APPLIC SUBMITTAL	03/14/09

DESIGNED BY: RC	DATE: 03/14/09
DRAWN BY: NL	SCALE: 1/4"=1'-0"
CHECKED: NL	
PROJECT: GLACIER RESORT CONDOMINIUMS GLACIER, WA	OWNER: MT. BAKER TRAIL HEAD GROUP INC PO BOX 28567 BELLINGHAM, WA 98228

A4.0

SHEET