

RELIEF VALVE TO BE PLUMBED TO THE EXTERIOR OF BUILDING. WATER HEATER TO BE PLACED ON 1 ST FLOOR CONSTRUCTION TO A MINIMUM OF 18" HIGH. U.P.C. 608.5
GLAZING IN HAZARDOUS LOCATIONS SHALL BE OF SAFETY GLASS. EACH LIGHT OF GLASS SHALL BE IDENTIFIED BY A PERMANENT LABEL VISIBLE AFTER INSTALLATION. IRC 308.1
PROVIDE AT LEAST ONE OPERABLE WINDOW OF NOT LESS THAN 5.7 S.F. OF OPERABLE AREA, WITH CLEAR MINIMUM HEIGHT 20" AND WIDTH 20". MAXIMUM SILL HEIGHT 44" ABOVE FINISHED FLOOR. IRC 310.1
WHOLE HOUSE VENTILATION SHALL COMPLY WITH THE 2006 WA STATE VENTILATION & INDOOR AIR QUALITY CODE 302.3 - ALL BATHROOMS, TOILET COMPARTMENTS, LAUNDRY ROOMS, CLOSETS CONTAINING LAUNDRY FACILITIES, AND KITCHENS SHALL BE PROVIDED WITH MECHANICAL MEANS OF A MECHANICAL FAN VENTILATION SYSTEM CONNECTED DIRECTLY TO THE OUTSIDE. VAQ SECTION 302
CENTRAL FURNACES SHALL NOT BE LOCATED IN SPACE LESS THAN 12" WIDER THAN THE FURNACE INSTALLED THEREIN. MINIMUM CLEARANCE FROM WALLS SHALL BE 3" ALONG ALL SIDES, BACK AND TOP OF THE FURNACE. IRC M1305 & M1701.4, IMC 303
APPLIANCES DESIGNED TO BE FIXED IN POSITION SHALL BE FASTENED OR ANCHORED IN AN APPROVED MANNER, IN SEISMIC DESIGN CATEGORIES D1 AND D2. M1307.2
WATER HEATER TO BE ANCHORED TOP AND BOTTOM TO RESIST HORIZONTAL DISPLACEMENT DUE TO EARTHQUAKE MOTION. STRAPPING TO BE WITHIN THE UPPER 1/3 OF THE APPLIANCE. U.P.C. 510.3 & 510.5
VENTILATION OPENINGS SHALL BE PROVIDED, WITH CORROSION-RESISTANT WIRE MESH, WITH 1/8" MINIMUM TO 1/4" MAXIMUM OPENINGS. IRC 806.1
22" x 30" ATTIC ACCESS W/1/2" DAM IRC 807.1

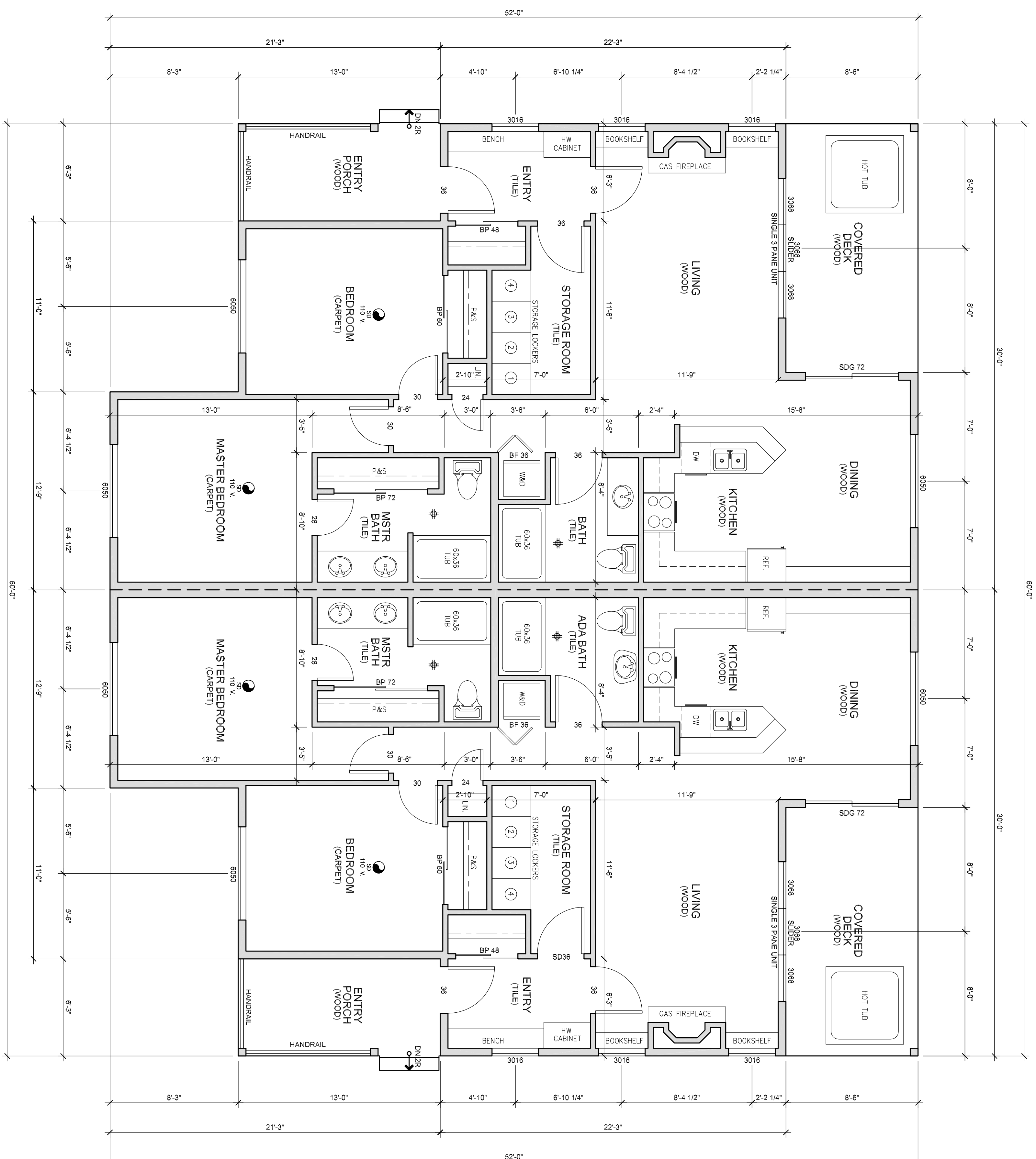

MAIN FLOOR PLAN
SCALE 1/4"=1'-0"

MAIN FLOOR (UNIT A): 1,200 SF
 MAIN FLOOR (UNIT A): 1,200 SF
 UPPER FLOOR (UNIT A): 1,200 SF
 UPPER FLOOR (UNIT B): 1,200 SF
TOTAL FLOOR: 4,800 SF

REVISIONS:	
CONDITIONAL USE APPLIC SUBMITTAL	03/14/09

DESIGNED BY: RC
DRAWN BY: NL
DATE: 03/14/09
SCALE: 1/4"=1'-0"
CHECKED: NL

PROJECT:
GLACIER RESORT CONDOMINIUMS
GLACIER, WA

OWNER:
MT. BAKER TRAIL HEAD GROUP INC
PO BOX 28567
BELLINGHAM, WA 98228

MT. BAKER TRAIL HEAD GROUP INC

PO BOX 28567
BELLINGHAM, WA 98228
PH: (360) 398-9333